

NORME DI ATTUAZIONE

aggiornate alla legge urbanistica provinciale 4 agosto
2015, n. 15 e al regolamento urbanistico edilizio
provinciale (DPP 19 maggio 2017, n.8-61/Leg)

SCHEMI ALLEGATI

Approvato con deliberazione del Consiglio Comunale
n° 04 di data 09.03.2020 - ADOZIONE PRELIMINARE

TETTOIA

LEGNAIA
1 ALLOGGIO

300

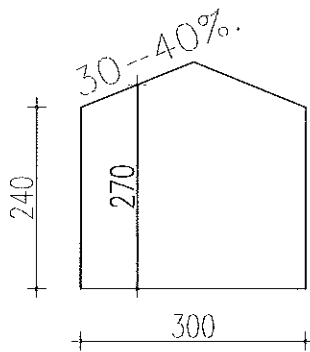
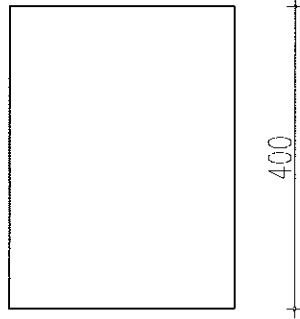

ART.5.8

LEGNAIA
E TETTOIE

CONTROLLO:

1 alloggio

$2.7 \times 12 \text{mq} = 32.4 \text{ mc}$

LEGNAIE
PIU ALLOGGI

500

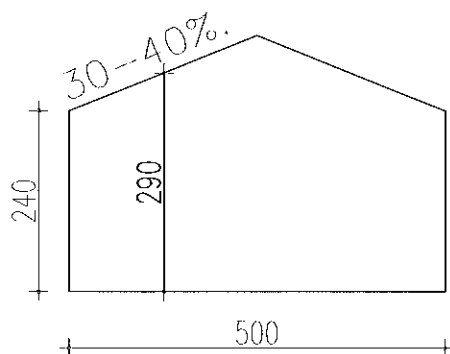
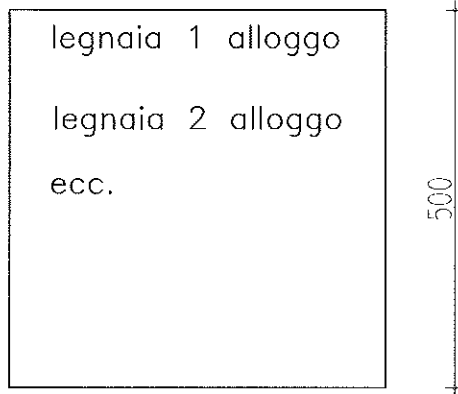

ART.5.8

LEGNAIE

CONTROLLO:

più alloggi

$2.9 \times 25 \text{mq} = 72.5 \text{mc}$

ART.5.11

attività principale

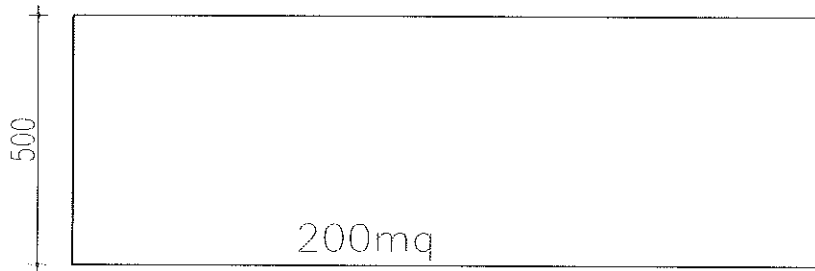

CONTROLLO:
attività principale
 $5.00 \times 200mq = 1000 \text{ mc}$

EVENTUALE COMMUTAZIONE:
 $200mq \times 5 = 1000mc$

$$\frac{200}{5} = 0.40$$

ART.31.1

RISTRUTTURAZIONE EDILIZIA

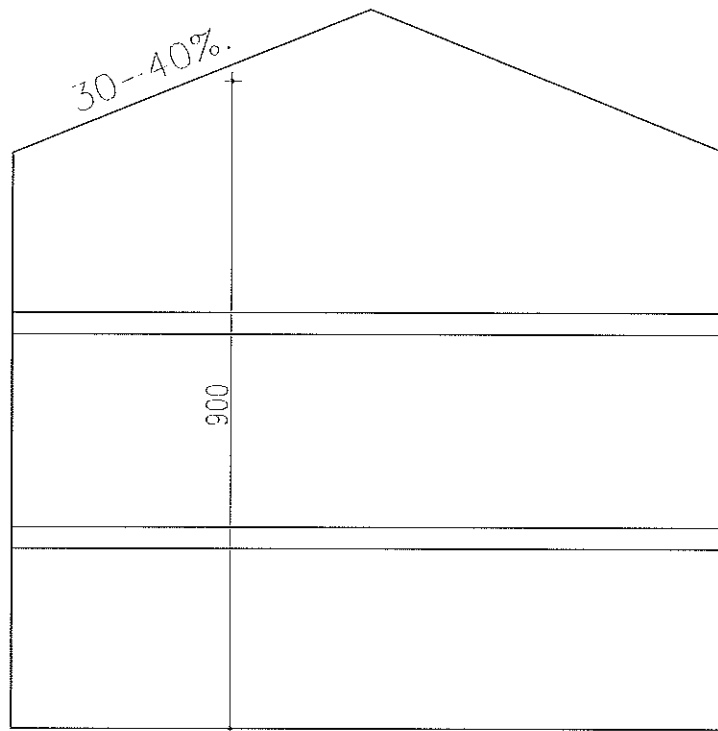

CONTROLLO:
RISTRUTTURAZIONE EDILIZIA

Volume $(9 \times 100) = \text{mc. } 900$

3 piani $\times 100\text{mq}$

SUL = 300mq

$900\text{mc} \times 20\% = 180\text{mc} : 3 = 60\text{mq}$

$60\text{mq} : 300\text{mq} = \text{coeff. } 0.20$

ART.39
RESIDENZA

COMPATTI

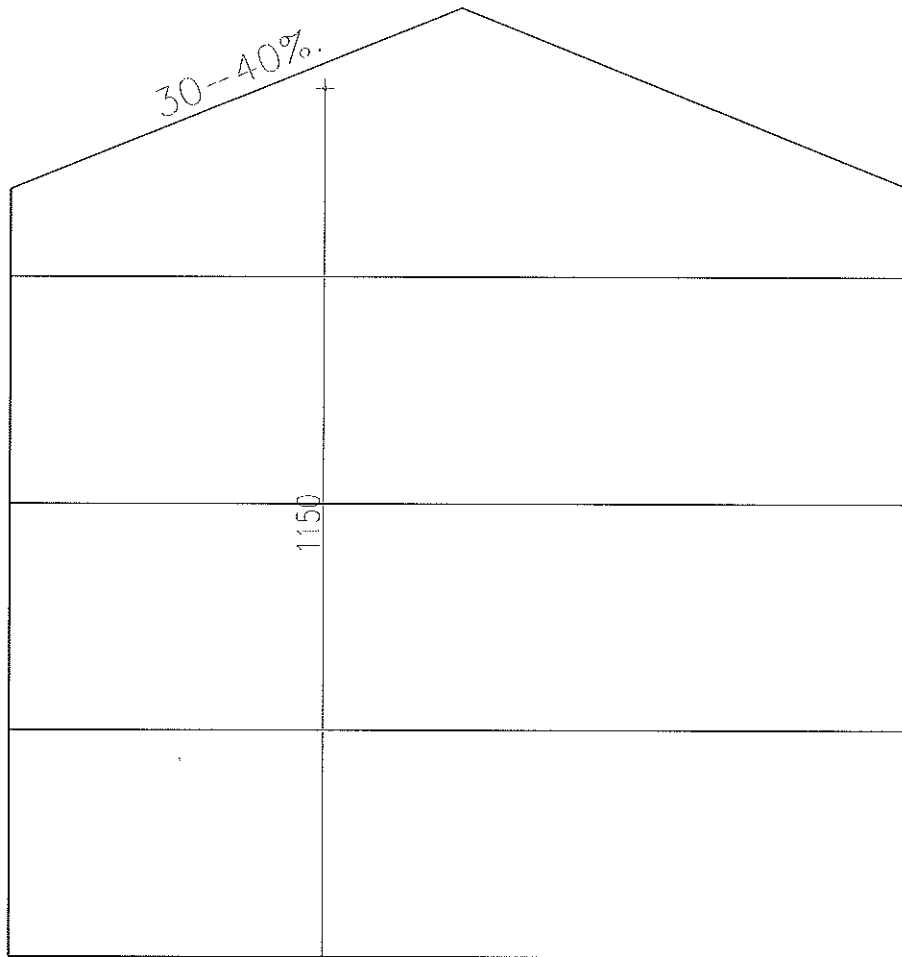

CONTROLLO:

3000 mc

$3000\text{mc}/11.5 = \text{mq.}261 \times 4 = 1043 \text{ SUL}$

$1043 - 20\% \text{ muri ecc} = 835 \text{ SUN}$

ART.39
ALBERGHI
COMPATTI

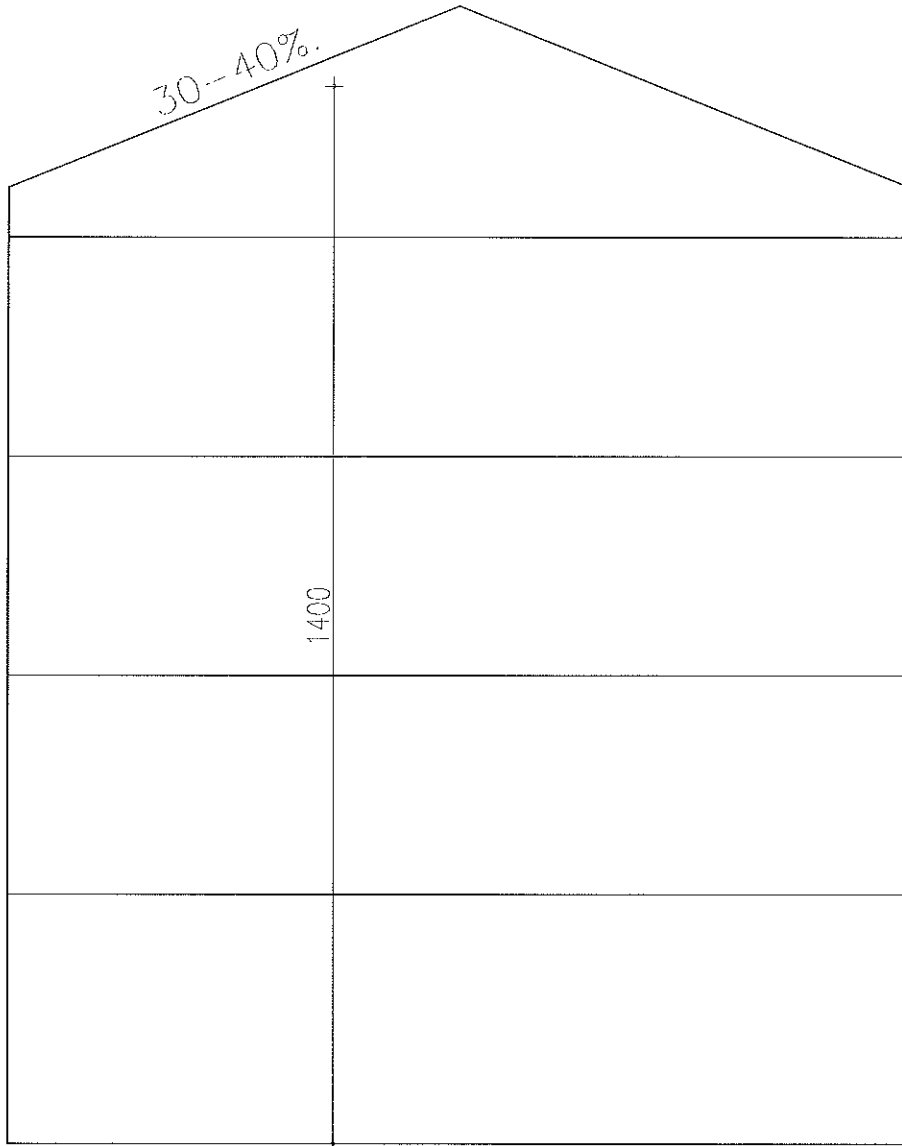

CONTROLLO:

12000mc

$12000\text{mc}/h \cdot 3.3 = \text{mq.}3636 \text{ SUL} \times -8\% = 3345$
SUN

ART.39
RESIDENZA
RADI

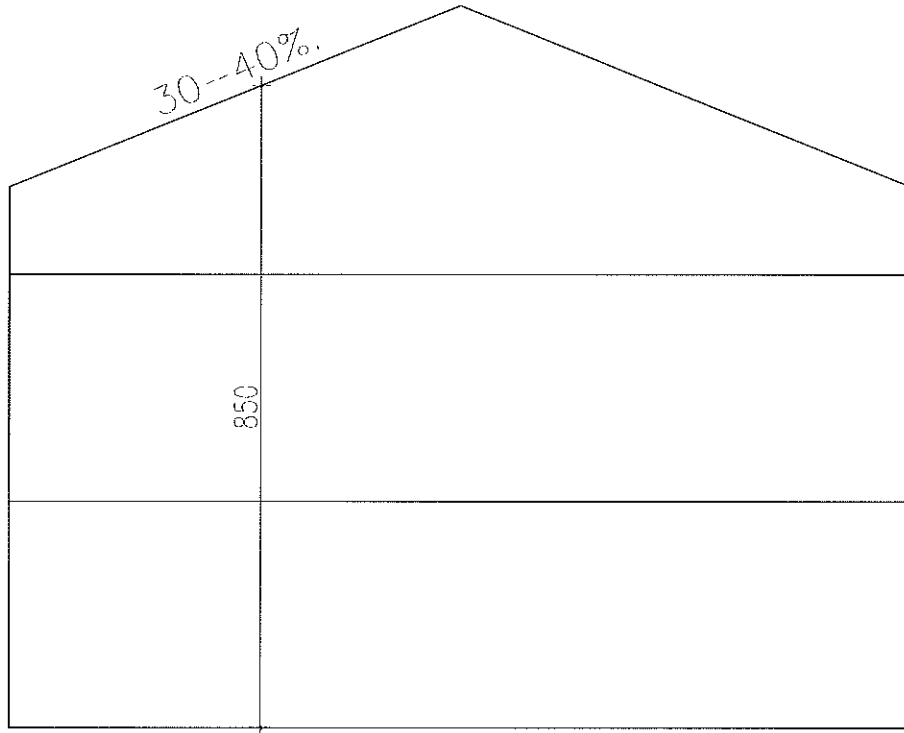

CONTROLLO:

1300mc

$1300\text{mc}/8.50 = \text{mq.}153 \times 3 = 459 \text{ SUL}$

$459 - 20\% \text{ muri ecc} = 367 \text{ SUN}$

MEDIA = 360

$1300\text{mc}/ \text{H.}2.90 = 448$

$-20\% = \text{SUN } 358$

ART.39
ALBERGHI
RADI

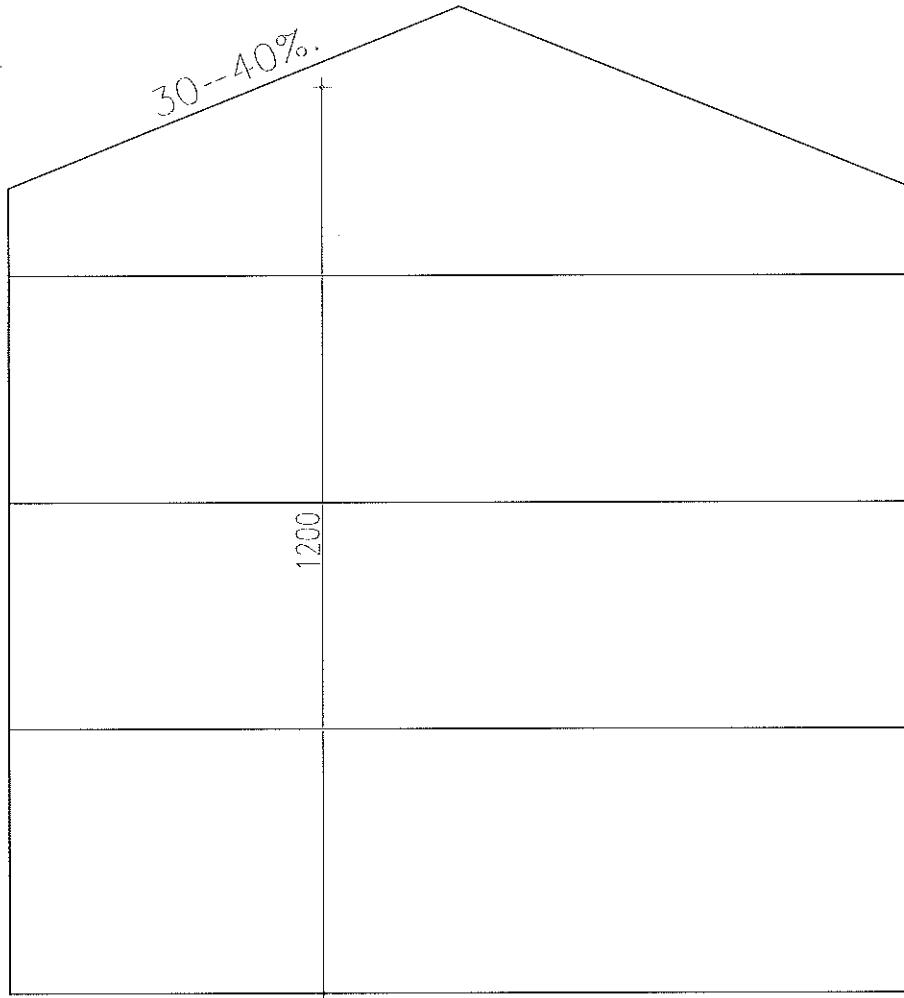

CONTROLLO:

4000mc

$4000mc / 3.3 = mq.1212 * -8\% = 1115 \text{ SUN}$

EVENTUALE COMMUTAZIONE
IN COEFFICIENTE

ART.41
ART.41BIS

MULTIFUNZIONALI
COMMERCIALI

VE 5000 MC

VE 5000 MC

IF 3 MAX

IF 2 MAX

$$\frac{5000}{3} = \text{MQ. } 1666$$

$$5000/2 = \text{MQ. } 2500$$

$$\begin{aligned} \text{H.9.00} &= 5000/9 \\ &= 555 \text{ SUL} \end{aligned}$$

$$\begin{aligned} \text{H.5.00} &= 5000/5 \\ &= 1000 \text{ SUL} \end{aligned}$$

COEFFICIENTE
=

COEFFICIENTE
=

$$\frac{555}{1666} = 0.33 \text{mq/mq}$$

$$1000/2500 = 0.40 \text{mq/mq}$$

$$\begin{aligned} \text{COEFFICIENTE} \\ &= 0.37 \text{ MQ/MQ} \end{aligned}$$

ART.47

VE 2000 MC

DEPURATORI ECC.

H. 6.00

= $2000\text{mc} : 6 = \text{MQ } 333$

$\text{MQ } 333 \times 2 = \text{ARROT.}$
660

ART.48

VE 4000 MC (pari 130.000 mq x
saturare)

AREE AGRICOLE

H. 8.50

= $4000 : 8.50 = \text{MQ } 470.6$

$\text{MQ } 470 \times 2 = 940 \text{ SUL}$

modello LOCALE;
10.000 mq superficie
massima: 1% = 100 mq

ART.51

$\frac{1}{3}$ DI PARAMETRI AREE AGRICOLE

PASCOLI

ART.52

VE 1000 MC

AREE IMPRODUTT

H. 5.00

= 1000 mc : 5 h= MQ 200

MQ 200 X 2p = 400 SUL

ART.58

piano attuativo

pr 1

MC 12.000

SUN = 3350 MQ
VEDI TAB. ART.39